

JUXTA D Series

General Specifications

Model DHO
OUTPUT ISOLATOR

JUXTA

1. General

This DCS correspondence nest stored type voltage output signal isolator inputs 1~5V DC signals and converts them into various volatge signals.

2. Specifications

Input & Output	
Input signal	1~5V DC
Input resistance	1M Ω (100K Ω when power off)
Permissible applied voltage	\pm 30V DC or less
Output signal	Voltage signal
Zero point adjustment range	\pm 1% of span
Span adjustment range	\pm 5% of span
Standard Performance	
Accuracy rating	\pm 0.1% of span
Response speed	150ms 63% response (10~90%)s
Insulation resistance	100M Ω or more (at 500V DC) between input~output, input~power supply and output~power supply
Voltage withstand	1500V AC/minute between input~output, input~power supply 500V AC/minute between output~power supply
Ambient temperature and humidity	Normal operating condition : 0~50 $^{\circ}$ C, 5~90% RH Operating limit : -10~60 $^{\circ}$ C, 5~95% RH Storage condition : -10~70 $^{\circ}$ C, 5~95% RH
Power supply voltage	24V DC \pm 10% (ripple content 10% p-p or less)
Effect of power supply voltage fluctuation	\pm 0.1% or less of span per 24V DC \pm 10% fluctuation
Effect of ambient tempearture change	\pm 0.2% or less of span per 10 $^{\circ}$ C temperature change
Current dissipation	24V DC 50mA
Mounting & Dimension	
Boards	Both sides glass-epoxy
Mounting method	Store in exclusive nest (signal-power supply be connected through back board and connector)
Wiring	External wiring : Connect to terminal M4 screw of input/output of exclusive nest. Connection to I/O card: By exclusive cable (connector)
External dimension	130.6 X 23.6 X 126mm (HxWxD)
Weight	About 120g
Accessories	
Tag number label ... 4	

Output resistance and permissible load resistance

(DC voltage output type)		
Output signal	Output resistance	Permissible load resistance
0~ 10mV DC	100 Ω or less	250K Ω or more
0~100mV DC		
0~ 1V DC	1 Ω or less	2K Ω or more
0~ 10V DC		10K Ω or more
0~ 5V DC		2K Ω or more
1~ 5V DC		2K Ω or more
-10~+10V DC		10K Ω or more
Others, in case of $V_{1..} \leq 100mV$		100 Ω or less
$V_{1..} = 10V$ or less $V_{1..} > 100mV$	1 Ω or less	10K Ω or more

$V_{1..}$ = 100% output voltage value

DHO-6 □ N * A

TYPE _____

INPUT SIGNAL _____
6 : 1~5V DC

OUTPUT SIGNAL _____

1 : 0~ 10mV DC
2 : 0~100mV DC
3 : 0~ 1V DC
4 : 0~10V DC
5 : 0~ 5V DC
6 : 1~ 5V D
0 : (CUSTOM) Voltage Signal
Span 10mV or more in the range of 0~10V DC

POWER SUPPLY
24V DC±10%

ORDERING INFORMATION
(Example) Type Code : DHO-66N*A

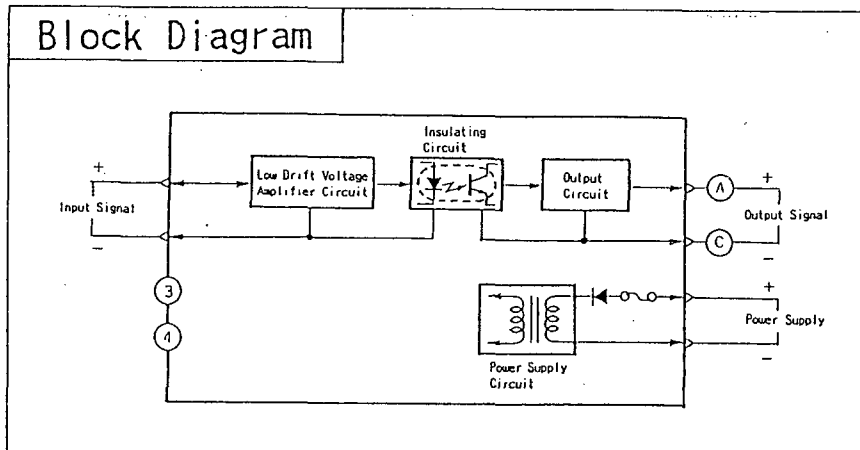

EXTERNAL DIMENSION

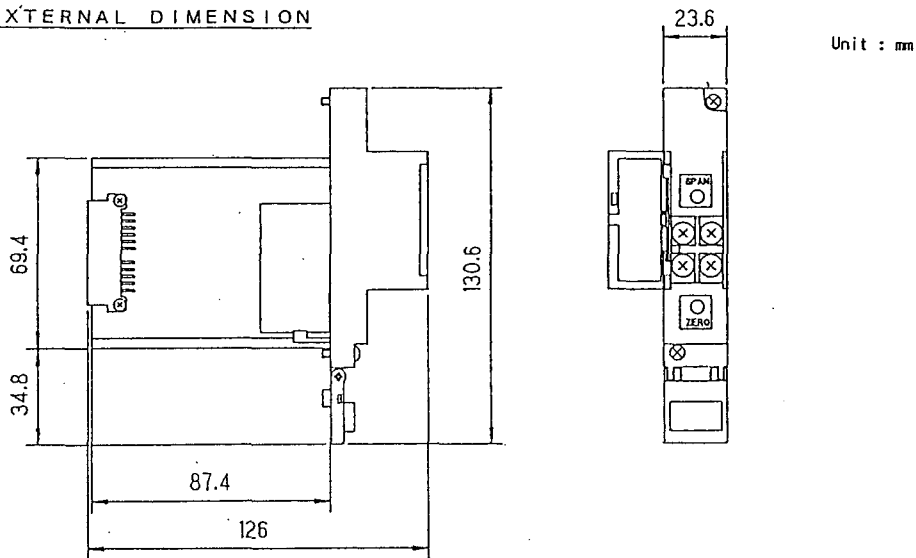

Subject to change without notice for grade up quality and performance